



www.kaupa.com.tw

# NEW BUTANE REFILLABLE HEAT GUN

kauplus®

## GT-9616



TECHNICAL INFORMATION	
Burning Time (min)	30
Gas Volume (mL)	30
Fuel Type	BUTANE (Normal lighter gas)
Flame Temperature (°C)	N/A
Soldering Temperature (°C)	N/A
Hot Air Temperature (°C)	600

## GT-9616

- A press-on design portable hot air generator for automotive repair, makers and hobbyist
- With child safety lock for children safety
- Up to 500W equivalent electrical power
- Can be easily refilled with butane gas or butane-propane mixture gas
- Designed with an innovative system for fast heat up to 650°C within 8 seconds. (Temperature is measured at the place 10mm from the nozzle.) It could help to improve the efficiency of your projects and save time.
- With continuous function for a run time up to 40 mins (one full refill), 25 mins in max power.
- Heat sink cage design for protection and safety
- Hand free design – use this tool with your two hands simultaneously
- 35mm stainless steel nozzle and can applied all kinds of 35mm nozzle tip on the market.
- Safe Refill System® for consumer safety – magazine type gas tank system
- Ideal for shrink tubing/wrapping, removing paint/floor tiles, bending plastic, thawing pipes, epoxy resin & crafts, etc.

## Innovation & Advantages :

- (1) The Hand Free Use Function :  
Pull out the "wing" to use the hand free function.

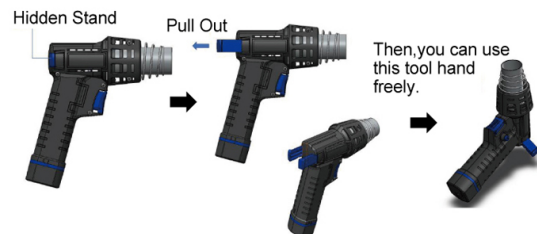

- (2) Magazine Type Refillable Gas Tank:  
Design for safety reason



## Accessory Options :

- (1) The refillable magazine type gas cartridge:  
Due to our special design system, you can buy this separately if they need to use this heat gun for a longer time



- (2) 4 different nozzles :  
A: Smaller diameter 20mm nozzle.  
B: Wider and flatter diameter 10\*75mm nozzle.  
C: Smaller diameter 22mm nozzle.  
D: Wider and flatter diameter 10\*75mm nozzle.



KAUPA  
APP



Android



IOS

E-mail: service@kaupa.com.tw

KAUPA INTERNATIONAL CO.,LTD



www.kaupa.com.tw

# NEW LI-ION POWERED HEAT TOOL SOLDERING & PLASTIC REPAIR KIT

**kauplus®**

## GT-9617-A



## GT-9617



**G1 Tip:**  
50W Cone type soldering tip, heat up in 8 seconds to reach working temperature. Max temp is 700°C/1300°F



With one AC adapter for different countries, picture is only for demonstration

## GT-9617-B



### G1~ G17 Tips option as below:

- G1~ G6: Soldering Projects Tips
- G7: Heat Shrink Project Tips (90W Heat shrink tip, heat up in 2 seconds to reach working temperature. Max temp is 600°C/1120°F)
- G8~ G11: Plastic Repair Projects (Automotive) Tips
- G8: 150W Three direction hot staple tip (becomes a cordless hot stapler), heat up in 3~5 seconds to work.
- G12~G17: Miscellaneous Projects Tips



## GT-9617-A & GT-9617-B

- Quick change the tips for the job you need, and we currently offer 17 tips for selection, for example: soldering project, heat shrink, plastic welding and hot staple.
- Two built-in rechargeable li-ion batteries provide 7.4 volt and 50W~150W high power tips.
- Power indication function
- Two bright white LED for illumination
- Built-in certified micro switch for safety
- Working time 30~40 mins
- Charging time 2.5~3hrs
- GT-9617-A : Soldering Kit with tip 1.4.7, lead free solder, brass mesh tip cleaner and packed in a blow case
- GT-9617-B: Automotive Plastic Repair Kit with tip 8.10.11, 25 pcs plastic welding rods (4mm dia ABS/PP/PE/PS and flat PP), 2 pcs reinforcing stainless steel mesh, 50 pcs flat staples 0.8 and 0.6mm, brass brush and cleaning rod. Packed in a blow case



E-mail: service@kaupa.com.tw

**KAUPA INTERNATIONAL CO.,LTD**



## GT-9619

### 5 IN 1 MITER SHEARS CUTTING TOOL SET



## GT-9573

### PROFESSIONAL RECHARGEABLE COLOR MATCH LIGHT

IP Rating	IP65, IK07	Light Source	LED
Color Temperature(CCT)	2700k-3500k-6500k	Support Dimmer	NO
Beam Angle(°)	60	Lifespan (hours)	20000
CRI (Ra>)	96+	Working Time (hours)	40000
Input Voltage(V)	AC 100V-230V	Lumen	500LM / 250LM
Lamp Luminous Efficiency (lm/w)	100	Working time	2hours
Lamp Luminous Flux (lm)	500LM/250LM	Charging time	4hours
Working Lifetime(Hour)	50000	Function	2700K-4500K-6500K-OFF ( 5mins switch to Low Level automatically)
Working Temperature(°C)	-20-50	Battery	3.7V 2600mah Li-ion Battery
Color Rendering Index(Ra)	96	Material	ABS housing +PC lens, Nylon hook
Emitting Color	White	Product weight	420g
Power Supply	DC	Product size	8.3*11.8*20CM

CRI 96+  
COB LED  
BATTERY  
INDICATOR



MAGNETIC CHARGING BASE

FOLDABLE HOOK

SWITCH  
MAGNETS

MAGNETS

3 COLOR MATCH COB LED CRI:RA96+  
COLOR TEMPERATURE: 2700K / 4500K / 6500K

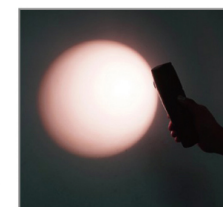

## BR-9110

### AUTOMATIC SLACK ADJUSTER RELEASE TOOL AND WRENCH



The fork end release tool can be allowed by hands-free operation to release the tensioner button and safely adjust the brake.



1pc double square reversible ratcheting wrench.

1pc fork-end release tool



516 offset square reversible wrench with EZ grip handle for adjusting the brake and capable to release the antireverse mechanism without prying.



Forkend designed tool able to fit securely under the pull pawl allowing hands-free operation to release the tension button.



## PC-9365

### MULTIPURPOSE BEARING AND PULLER SET



## PC-9364

### CHASSIS HEIGHT MEASUREMENT TOOL 320MM



## TT-9307

### ENGINE TIMING KIT FOR VAUXHALL VEHICLES

• Used on the following Vehicles: Opel / Vauxhall Corsa - E 2015 to 2017 CDTi Engine Codes: 1.3ccLKU / B13DTE, LKU/B13DTR, LKV / B13DTC

#### Contents:

- 1 x Crankshaft pulley hub holding tool
- 1 x Camshaft position (CMP) sensor disc setting tool
- 1 x Two piece inlet camshaft gear alignment tool
- 1 x Timing chain front cover alignment tool
- 1 x Timing chain tensioner locking pin
- 1 x Crankshaft pin - OEM EN
- 2 x Camshaft locking tools



## PLC-9095

### 9" HOSE CLAMP PLIERS

- Length: 230mm
- Material: Carbon Steel With H/T With spring
- Jaw max opening: 90mm



In narrow engine room, a compact & convenient hose clamp pliers let jobs easier. An ideal design, balance between size and labor-saving



- Machine made waffle shape grip jaw.
- Secure the hose clamp grip tightly.
- Large gripping area, easy to grip from any direction.

## PLC-9094

### FLAT HOLE PLIERS



Suitable for holes above 5mm

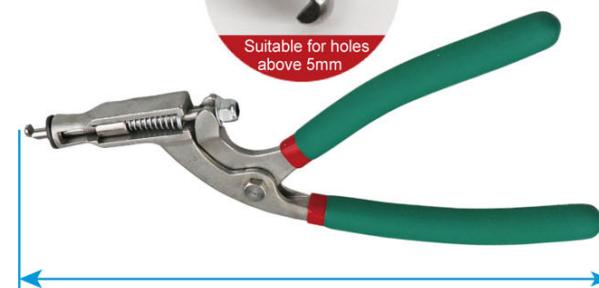

24CM.

## PLC-9093

### EAGLE MOUTH PLIERS



## PLC-9096

### 10" QUICK ADJUST WATER PUMP PLIERS (250MM)



A maximum clamping range of up to 60mm

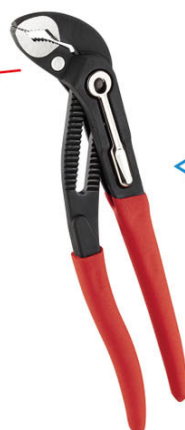

- Quickest possible adjustment with closed pliers' s hanks directly at the workpiec while gripping.
- Comfortable quick adjustment lever help adjustment without re-gripping.
- Self-locking on pipes and nuts: no slipping on the workpiece and low hand force required.
- Gripping surfaces with special hardened teeth, teeth hardness approx, 60 HRC: high wear resistance and stable gripping.
- Reliable catching of the hinge bolt: no unintentional shifting.
- Guard prevents operators' fingers being pinched.
- Chrome Molybdenum steel, forged, multi-stage oil hardened.



Special angle teeth, can one way push to fit workpiece

#### Press-Free

The integral clamping protection prevents injuries

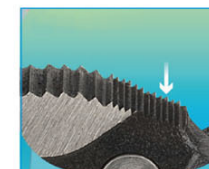

Inside extension tiny teeth strengthen the gripping.