



www.kaupa.com.tw

## GT-9445-1

### CARRY FREE OPERATING PLATFORM



- **Weightless Operation**  
Users can operate easily and FREELY in all-direction by Air Spring Tech (Patented)
- **Flexible Move**  
By small volume and light weight with 8" tires, users can operate so easily and move fast.
- **Easy Carry into Cars**  
1" wrench and platform are detachable, so mobile repair service can be everywhere.
- **Reasonable Price**  
With exclusive design and longer lifespan, users deserve reasonable price for working.
- **Versatile Application**  
Carry-free for all tools, machines, equipment.
- **Dimensions:** 23"L x 17"W x 67"H    **Weight:** 66LBS (30KGS)    **Load Capacity:** 20~90LBS (10~40KG)

## GT-9517

### FIBERGLASS RESCUE HOOK WITH FOAM FILLED 1.65M



- The 35kv Insulated Rescue hook is designed for rescuing those who are being subjected to electrical shock without having to directly touch the person being shocked.
- The High Voltage Rescue Crook is a 45 kV rescue stick that measures 1.65m long.
- Constructed from white resin polyester and 34mm fibreglass foam-filled tube.
- It also comes complete with a wall-mounted rack.

## GT-9513

### CLAMP TENSIONER



- **Specification:** Long way tool with a ratchet wrench
- **Capacity:** 3/8" clamp



E-mail: service@kaupa.com.tw

KAUPA INTERNATIONAL CO.,LTD



www.kaupa.com.tw

## SAFETY FACESHIELD- GLASSES TYPE

GT-9518



SIDE

- Color: Transparent shield
- Material: PET
- Package list: 1 x face shield  
1 x glasses holder

CE Certified.  
FDA Certified.

- Nontoxic material: Premium quality material, stain resistant, odorless, safe and healthy.
- Function: Effectively prevent exposure of virus- such as COVID-19. <At a distance of just 18 inches from a coughing individual, face shields have been shown to reduce immediate viral exposure by 96%, according to a study using influenza virus (Lindsley, J Occup Environ Hyg 2014)>
- Convenient to wear: Half-frame design fits for both men and women, suitable for those people wearing glasses.
- Anti-fog: Anti-fog coating on double-sides of lens to maintain clarity while cooking.

### Application



\*User photos capture from Internet

- Size dimension: 250mmx190mm  
To provide large coverage over the face

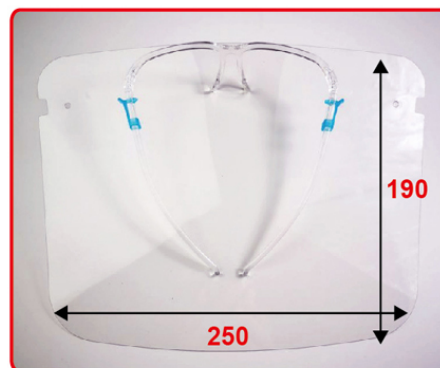

KAUPA  
APP



Android



IOS

E-mail: service@kaupa.com.tw

KAUPA INTERNATIONAL CO.,LTD



www.kaupa.com.tw

## 3-IN-1 MULTI-FUNCTION LIGHT - WHITE & UVA LIGHT

**GT-9519**



Other Option:  
White and yellow  
light

180°  
Rotation

**A**

**B**

**C**

**D**

**E**



- The unique 3-in-1 design can meet all you need completely.
- Simply replace the light heads to become the multi-function work lights, such as professional flashlight, super bright work light and UVA light.

- Power output: 5.0V 2000mAh
- Charger input: AC100~240V 50/60Hz
- Charger time: 2.5~3.0 hours
- Half bright time: 7 hours+
- 18650 Li-ion 3.6V 3350mAh Rechargeable Battery
- LED Charging Indicator: Red Light On - in charging, Blue Light On - completely charged
- BOX Weight: 880G
- Storage temperature: -20°C to 70°C
- Operation temperature: -5°C to 50°C
- Do not immerse the LED light in water / solvent
- Do not shine the LED light directly on anybody's eyes.
- Active time: Up to 3 hours+

- **A:** Max power: 600 Lumens 6.6W NICHIA LED. Size: 73(L) X 37(W) X 32(T) mm Weight:55 G
- **B:** Max power: 600 Lumens 8W COB LED Size: 230(L) X 37(W) X 32(T) mm Weight:95 G
- **C:** UVA LED. Size:230(L) X 37(W) X 32(T) mm Weight:95 G
- **D:** Body Size:103(L) X 37(W) X 32(T) mm Weight:120 G
- **E:** Charger

KAUPA  
APP



E-mail: service@kaupa.com.tw

**KAUPA INTERNATIONAL CO.,LTD**





# 1/2" Dr Anti-slip Thin Wall Wheel Lug Socket

ST-9442

15mm



21mm



22mm



17mm



19mm



KAUPA INTERNATIONAL CO., LTD.



## 1/2" Dr Anti-slip Thin Wall Wheel Lug Socket

ST-9442



Patented Anti-Slip design working for standard, rusted 85% up damaged and rounded lug nuts as well

**REMOVE 85% ROUNDED OFF FASTENERS**

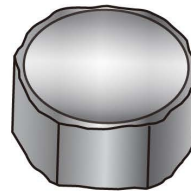
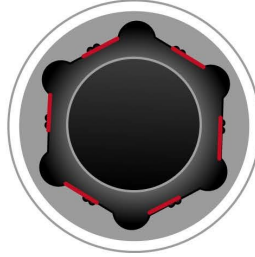
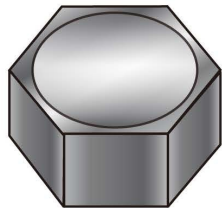
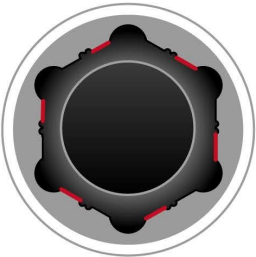

0% Forming

85% Rounded off





www.kaupa.com.tw

## PC-9237

### POWER STEERING PUMP PULLEY KIT



- The Pulley Puller and Installer Kit is great tool for removes and install power steering pump pulleys of most domestic vehicles, fits pulley hubs with diameters of 1-1/8 inch, 1-1/4 inch, 1-5/16 inch and 1-3/8 inch. This tool set contains each of steering pump remover, Pump pulley installer (with 3/8"x16/8mm x1.25 bolt screw), collar retaining, 3/8"x16 bolt screw, pressure screw extended, power steering pulley spacer, and set of collar halves with the adapters for several different vehicle models: **GM 2.3L Quad 4 four-cylinder engines; GM 3.1L, 3100, 3400, and 3800 V6 engines.**

## PC-9344

### PULLER, HARMONIC DAMPER PULLEY



- New spring-loaded legs allow for leg position retention
- Provides greater ease and control when installing the puller in confined areas
- Removes harmonic damper pulleys found on many Chrysler and GM engines
- Used on autos, pickups, SUVs, and vans



## TT-9276

### FORD CAMSHAFT ALIGNMENT KIT -3PCS



- The flat bar and long TDC timing pin are used on 1994-2003 Ford and Mercury vehicles with 2.0L DOHC Zetec engines.
- The flat bar and short timing pin are used on 2004-2012 2.5L DOHC, 2.3L DOHC engines that are found in Ford, Mercury and Mazda vehicles.
- The flat bar can also be used by itself on 2.0L DOHC engines in 1993-1994 Ford Probe.

## TT-9226

### ENGINE TIMING TOOL KIT CHRYSLER, JEEP



- Chrysler Grand Voyager and Jeep Cherokee
- Applications: Jeep Cherokee 2.8CRD with Engine Code ENS (51C) from 2008-2011 and Chrysler Grand Voyager with Engine Code VM64C from 2008-2011
- Includes crankshaft and exhaust camshaft locking tools

KAUPA  
APP



Android



IOS



E-mail: service@kaupa.com.tw

KAUPA INTERNATIONAL CO.,LTD