

## BS-9388

### PDR 7PCS TAP DOWN & SCRAPER TOOL KIT



- Material: POM < Polyoxymethylene >
- 1PCS 8-1/4" X 1/1/4" Wedge
- 1pcs 10" chisel scraper
- 5PCS TAP DOWN TOOLS
- 1pcs 10" chisel scraper

#### Features:

- Painless repairing car dent body, does not damage the original paint.
- Simple operation, repair the dent in quickly.
- Different shape head, which can be used for the different size of dent.
- Easy to control, you can removal the dent by yourself.

## PLC-9077

### 10" X JAW LOCKING PLIER- AMERICAN TYPE

- Classic trigger release that provides maximum locking force.
- The new design is ideal for the professional tradesman working extensively with round pipe, smaller diameter iron pipe, or places where a pipe wrench can't reach.
- Self energizing lower jaw is ideal for tightening, clamping, twisting and turning and provides maximum grip.



## BR-9100

### FLARING TOOL 4.75MM DIN & 3/16" SAE

- DIN CONVEX 4,75 mm flaring
- SAE DOUBLE 3/16 " flaring
- Easy and fast handling, also applicable directly on the car
- Very compact design for use in confined space

## GT-9566-B

### 5 IN 1 SWIVEL MITER SHEARS CUTTING TOOL SET

#### Features:

- Labor-saving structure: sectional positioning enables user to take breaks during cutting/shearing to lessen hand fatigue.
- Progressive positioning during cutting enables user to close the cutter automatically after cutting.
- Safety design minimizes exposure of sharp edge of cutter.
- Adjustable cutting angle.
- Multipurpose miter snip with 5 angle plates and blades included for interchange.
- Robust shears for cutting window UPVC trims, gasket seals and miter joints.

#### Application:

- Cuts PVC and small wooden moldings.
- Heavy-duty cutting of window UPVC trims, gaskets and miter joints.
- Cuts round plastic tubes, hoses, branches etc.



## OI-9119

### 2L MANUAL BRAKE BLEEDER FOR MOTORBIKE WITH 4PCS ADAPTORS

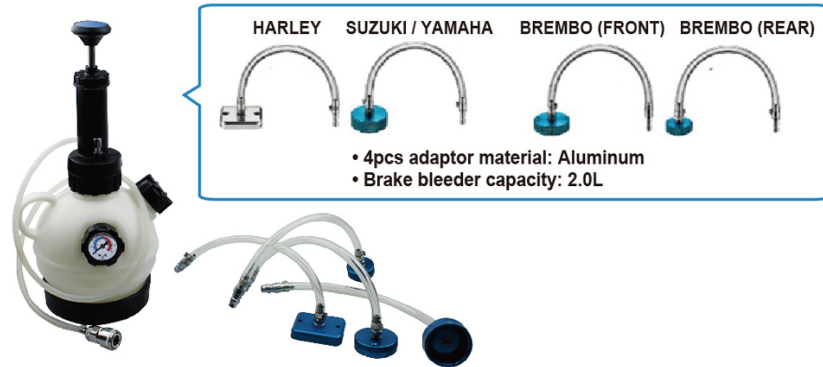

## OI-9152

### 1L VACUUM BRAKE FLUID BLEEDER FOR MOTORCYCLE

Connector for single wheel bleeding



- Vacuum brake bleeder complete with motorcycle attachment.
- 1 lite capacity
- Uses standard workshop air supply.
- Removes fluid via bleed nipples to allow bleeding or entire fluid replacement.



## TS-9114-A

### CYLINDER COMPRESSION TESTER FOR MOTORCYCLE

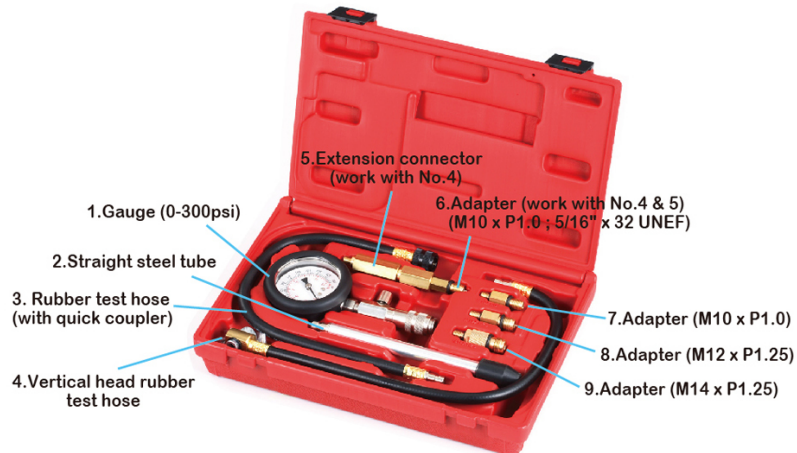

## OI-9153

### WASTE OIL RECEIVER-STORAGER-4L

- This drain pan have a broad appeal and are suitable for both the DIY user and professional mechanic.
  - Purpose made for the recovery of oil and anti-freeze, these pan help keep the workshop floor free from oily residue and aid return of oil to recycling container with minimum risk of spills or splashes.
  - Made from high density polyethylene
  - Heavy wall construction stays rigid, even with hot oil.
  - Large handle positioned to aid carrying and pouring.
  - Resistant to most chemicals and solvents.
  - Will not dent or rust and are easy to clean
- Dimension: 435 x 310 x 115 m/m
  - Weight: 600g
  - Capacity: 4L





## PC-0046

### BALL JOINT SEPARATOR 20-22MM

- Forged
- Clamping range in 2 positions adjustable: up to 30 and 55 mm
- For extracting the ball joints on tie rods and stabilizers

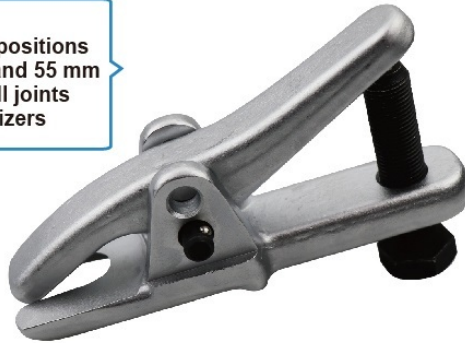

## TT-9218-E

### BMW TIMING TOOL KIT- S65

- For adjusting the engine timing, when replacing the timing chain, cylinder head gasket, etc.
- Suitable for following models with S65 engines: BMW M3 E90 / E92 / E93 (2007) Wiesmann MF4 (2009)



## TT-9229

### TIMING CHAIN GUIDE TOOL MERCEDES BENS 651

- Prevents skipping of chain and moving of camshaft sprockets when replacing the timing chain
- Removing of camshaft sprockets is not required
- Allows precise positioning
- Suitable for the following models: Mercedes-Benz engine OM 651 series



## TT-9238

### BMW BALANCER SHAFTS REMOVING AND REFITTING KIT <N20>

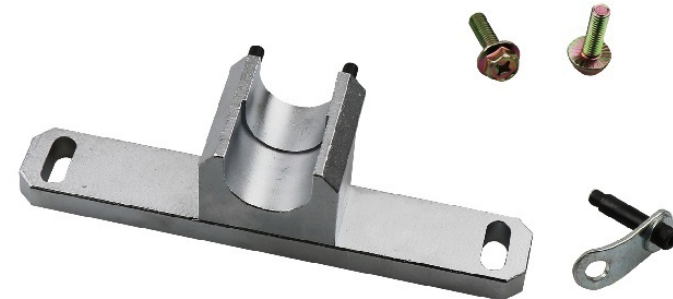

- For fixing the balancer shaft and holding chain sprocket
- To be used for repairing the chain and sprocket wheel drive



www.kaupa.com.tw

## TT-9263

### 4PCS BMW TIMING TOOL

#### Feature:

- This is an engine timing support tool for BMW 1.2, 1.5, 2.0 petrol and diesel engines

#### Additional Information:

- Applications: BMW 1,2,3,5 Series (2014-2017), 4, 7 Series (2015-2017), X1, X3, X4 Series (2014-2017), X5 Series (2015-2017), Mini Clubman (2014-2017), Mini Hatch (2015-2017), Mini convertible (2016-2017)
- Engine codes: B37, B38, B47, B48 (1.2L, 1.5L, 2.0L)
- Equivalent to OEM tools: 11 6 480, 11 9 811, 11 9 265, 11 4 180



## TT-9290

### ENGINE TIMING TOOL OPEL VAUXHALL

#### • Introduction:

2.0CDTi timing belt tool kit for OPEL/vauxhall for removal and replacement of the camshaft drive belt.. the kit also contains the tool required lock the Flywheel on vehicles fitted with Automatic Transmission.

N.B: for replacement of the camshaft drive chain in the cylinder head additional tooling will be required –HL-8952.

#### • OEM NO.:

EN-51413, EN-955-2, EN-51412, EN-51414, EN-51411

#### • Application(s):

Opel/Vauxhall: Cascada(15-17), Insignia(14-17), Insignia Country Tourer(14-17), Zafira C Tourer(14-17)

#### • Engine Codes: 2.0:LFS/B20DTH



## TT-9291

### DIESEL ENGINE TIMING TOOLS KIT FOR CHRYSLER /JEEP/ GM2.8

- 3Pc crankshaft and camshaft locking tool set for GM/Holden Colorado and Jeep/Chrysler 2.8D CRD engines. This allows the removal and replacement of the timing belt while maintaining the timed position.

#### • Application:

##### - Model:

- 1.Jeep: Cherokee (2008-2011)
- 2.Chrysler: Grand Voyager
- 3.MC: ENS (51C), VM64C
- 4.Holden: Colorado

#### - Contents:

- A.VM.9991 Crankshaft Locking Tool
- B.VM.9992 Exhaust Camshaft Locking tool



## TT-9292

### FLYWHEEL LOCKING TOOL HYUNDAI & KIA

- Introduction: Flywheel locking tool for Hyundai & Kia petrol engines from 2007 to 2018. Used to lock the flywheel via the starter motor aperture.

#### • OEM No. : 09231-2B100

#### • Application:

- Accent, Elantra, i10, i20, i30, i40, ix20, ix35, Santa fe, Tiburon, Tuscon, Veloster

- Kia applications from 2007 include: Carens, Cee d, Optima, Picanto, Pro-Cee'd, Rio, Sedona, Sorento, Soul, Sportage, Venga

- Engine codes include: 1.0 G3LA, GELC 1.2, G4LA 1.4, G4LC, G4FA 1.6, G4FC, G4FD, G4FJ 2.0 G4KD, G4KF, G4NC, G4NA, G4ND, G4NE 2.4, G4KE, G4KJ 2.7 G6BA

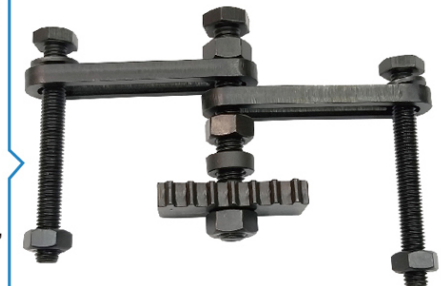

KAUPA APP



Android



IOS



E-mail: service@kaupa.com.tw

KAUPA INTERNATIONAL CO.,LTD